



OFFERS OVER

£300,000

Commissioners Wharf

North Shields, NE29 6DN

Fresh Property Centre welcome to the market this charming house on Commissioners Wharf, North Shields. The home offers a delightful blend of modern living and stunning views. With three well-proportioned bedrooms, this property is perfect for families or those seeking extra space. The master bedroom benefits from an ensuite shower room.

The heart of the home is the inviting reception room, which is designed for both comfort and style. The modern fittings throughout the property enhance its appeal, ensuring a contemporary lifestyle. The downstairs WC adds convenience for guests and family alike.

One of the standout features of this property is the balcony, which boasts breathtaking views of the marina.

For those with electric vehicles, the garage is equipped with a car charge point, making it an eco-friendly choice. This home not only offers practicality but also a lifestyle that embraces the beauty of its surroundings.

3



2



1





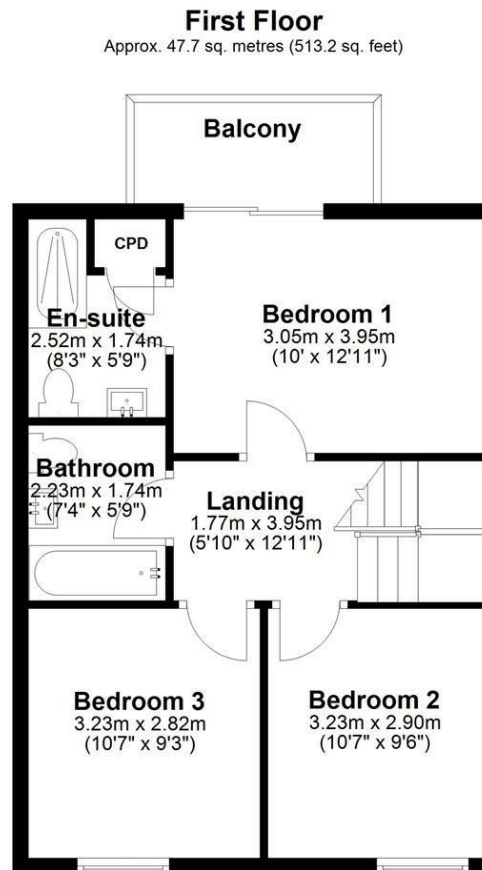
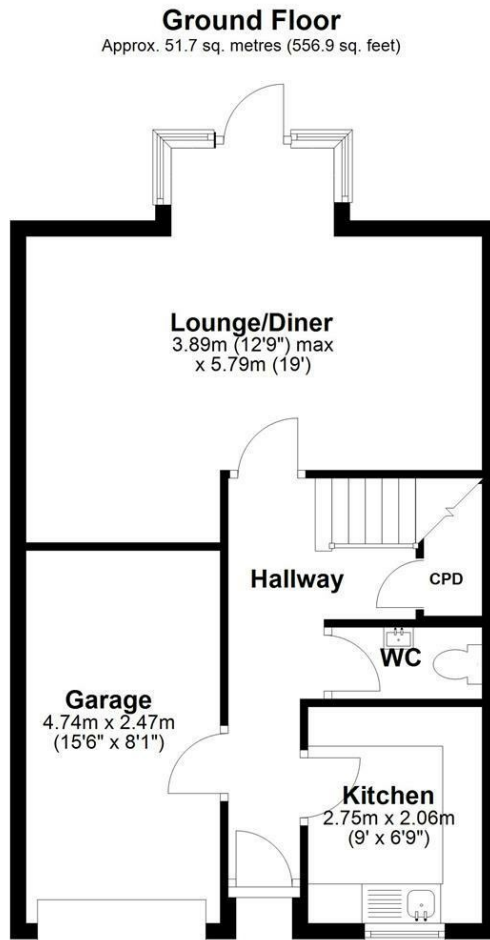

Total area: approx. 99.4 sq. metres (1070.1 sq. feet)

LOCAL AUTHORITY

North tyneside

TENURE

Freehold

COUNCIL TAX BAND

D

VIEWINGS

By prior appointment only

Energy Efficiency Rating		
	Current	Potential
Very energy efficient - lower running costs		
(92 plus) A		
(81-91) B		
(69-80) C		
(55-68) D		
(39-54) E		
(21-38) F		
(1-20) G		
Not energy efficient - higher running costs		
England & Wales	EU Directive 2002/91/EC	

Agents Note: Whilst every care has been taken to prepare these particulars, they are for guidance purposes only. All measurements are approximate and are for general guidance purposes only and whilst every care has been taken to ensure their accuracy, they should not be relied upon and potential buyers/tenants are advised to recheck the measurements



OFFICE ADDRESS
63 Church Way
North Shields
Tyne & Wear
NE29 0AE

OFFICE DETAILS
0191 257 6823
hello@fresh.property
www.freshpropertycentre.co.uk